

B101

«Hospital without pain»/ Children's Cancer Center

ACTUALITY OF THE PROBLEM

Today, the problem of cancer in the health sector is acute, both among adults and among children. Planning for specialized pediatric oncology centers is necessary because during the treatment it is important to take into account the peculiarities of child psychology and mood of the place. Children in need of complex treatment, taking into account the emotional state.

The sudden change in the environment, getting to the hospital is a severe shock to the child. The consequences are a passive attitude to the treatment of irritability. To deal with negative emotions is necessary because development leads to the decadent state, depression, suicide. In order not to deprive children of childhood, the aim of a development project is to implement the concept of «Hospital without pain».

SOLUTION

Nature is the source of human vitality, nature calms and «understands». Animals and plants help to create a positive attitude on the unconscious level. The main method of implementation of these tasks is to further the progressive method of treatment and maintenance of therapeutic effect pet therapy.

Introduction «zoological and botanic gardens» to the main public space of children's cancer center is a means of implementing the concept. The main public space Hospital holds a dominant position in the structure of the hospital, linking together all the blocks Cancer Center.

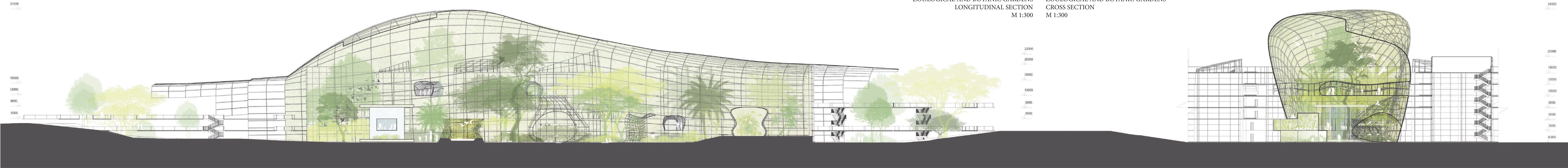
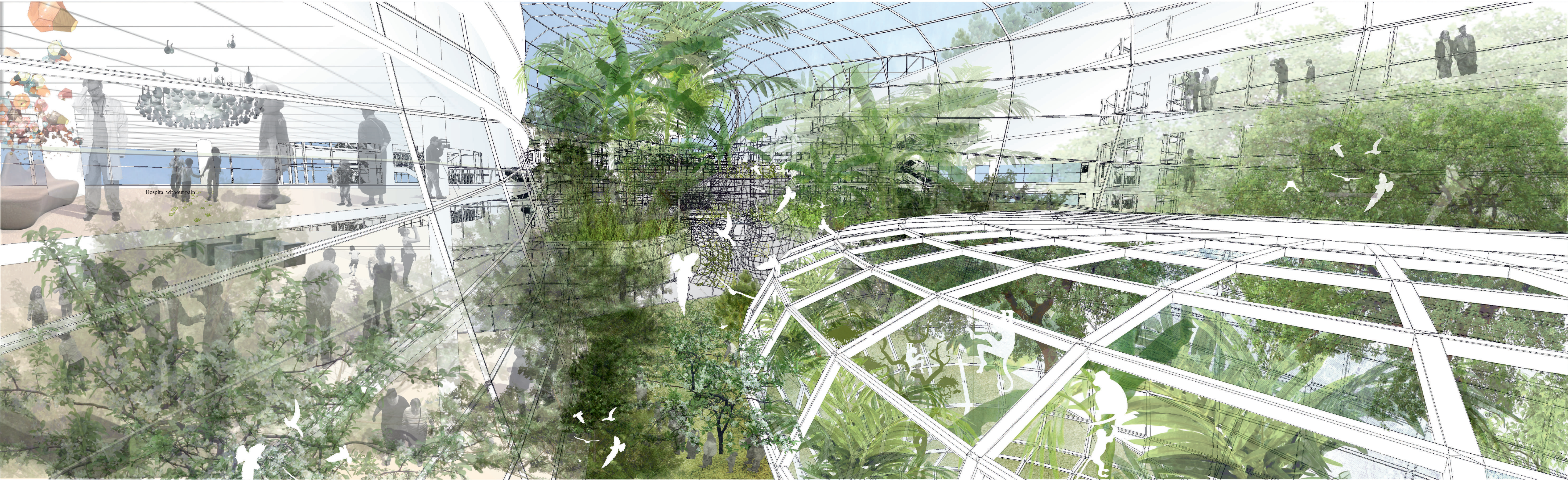

3788

3422

SPECIAL SPACES

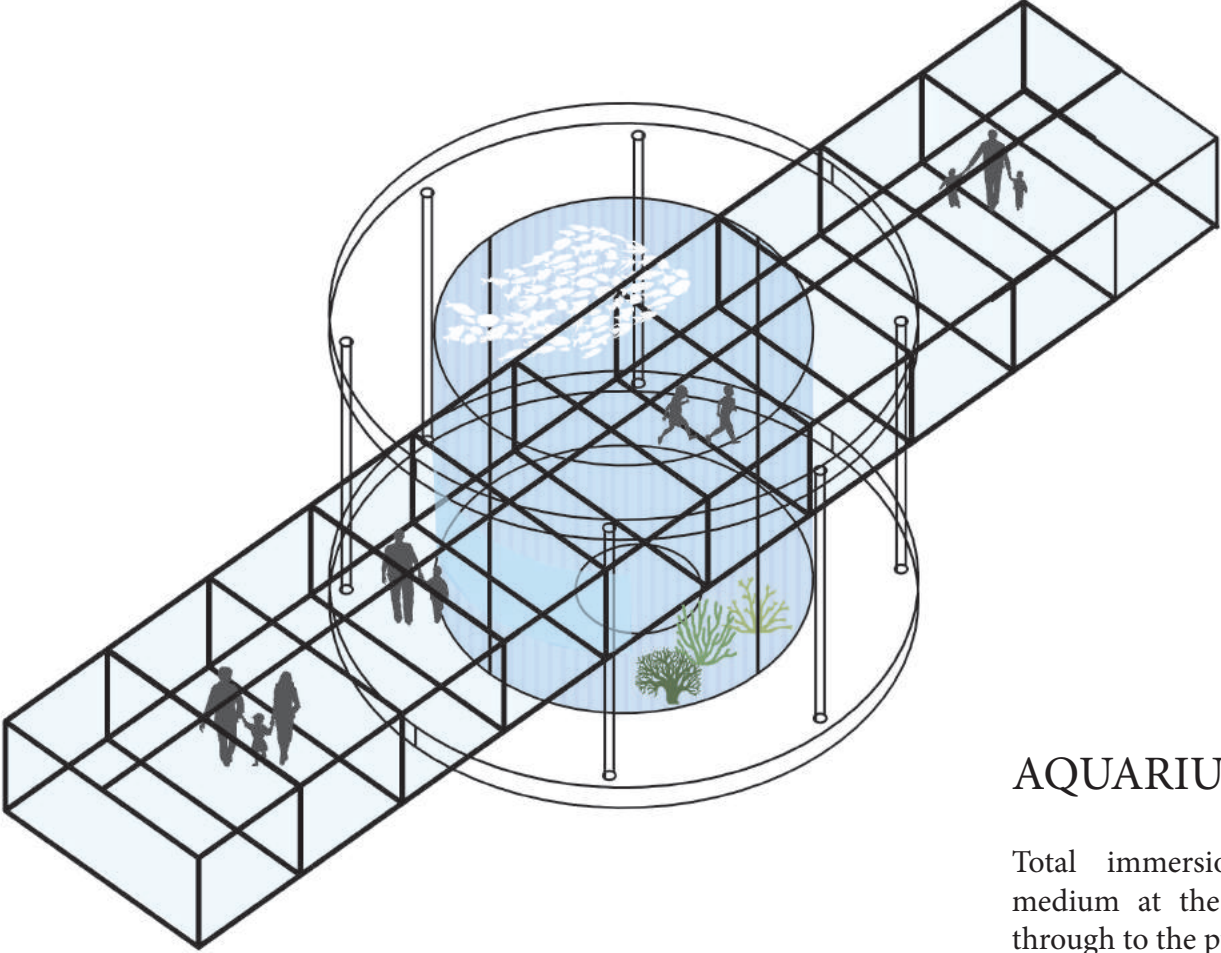

AQUARIUM

Total immersion in an aqueous medium at the expense of transfer through to the public.

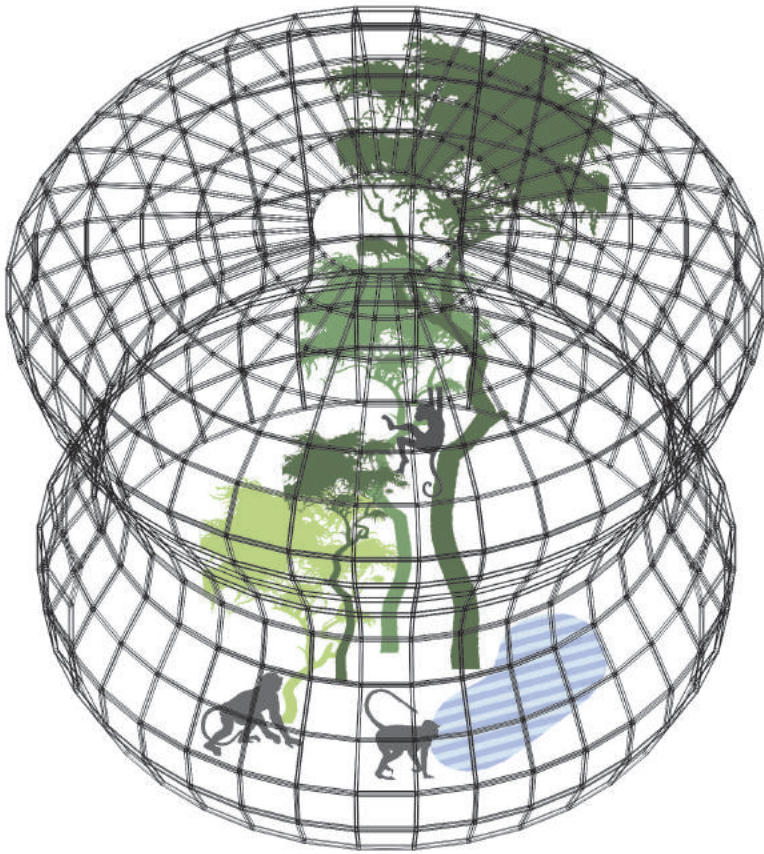

MONKEY HOUSE

One space allows visual contact with animals from all sides.

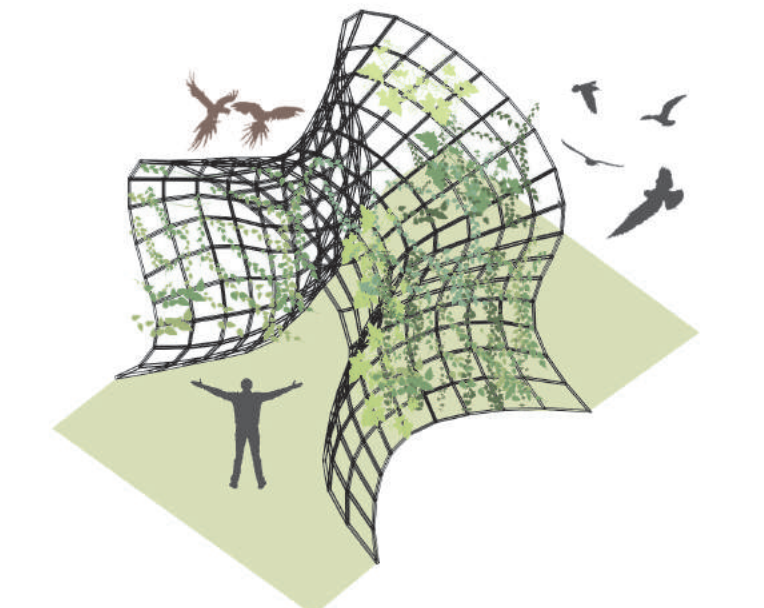

TUNNEL

Imitation immersion in natural oases tunnels by forming a curved frame for plant growth.

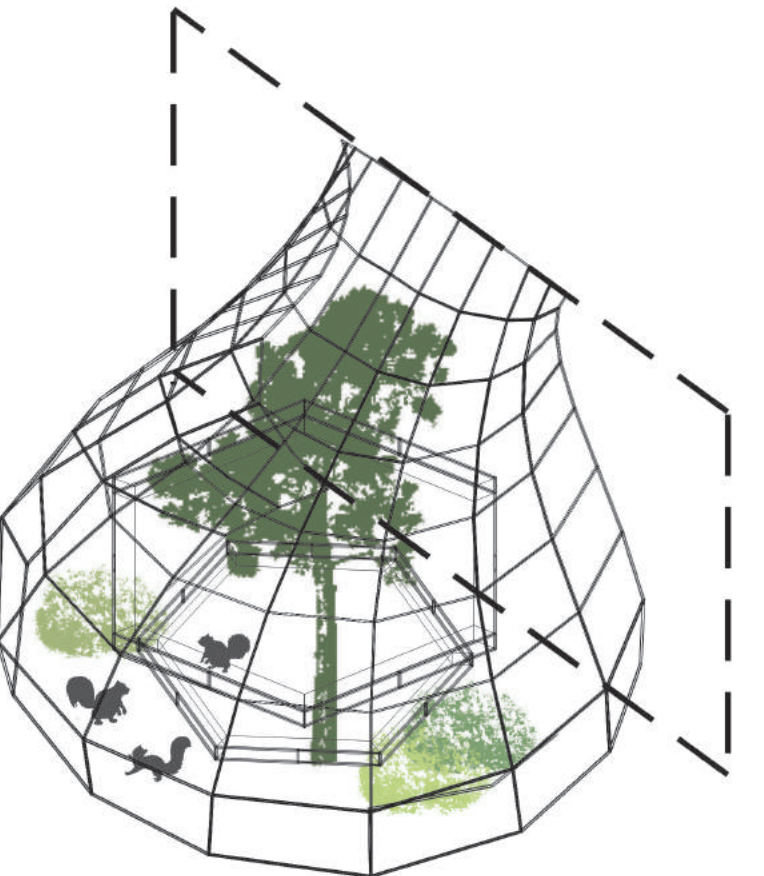

RODENTS

The space is in direct visual contact with the outside of the shell zoological and botanic gardens.

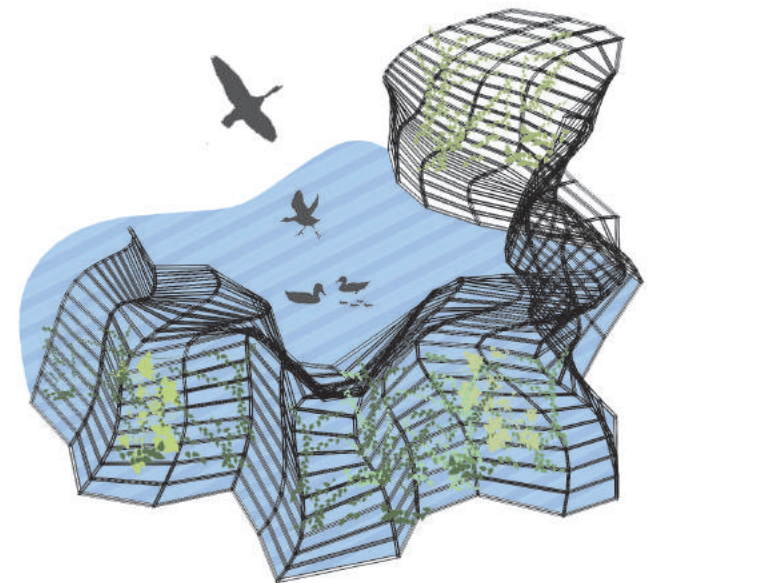

LAGOON

Formation of the semi-closed environment of aquatic birds and plants.

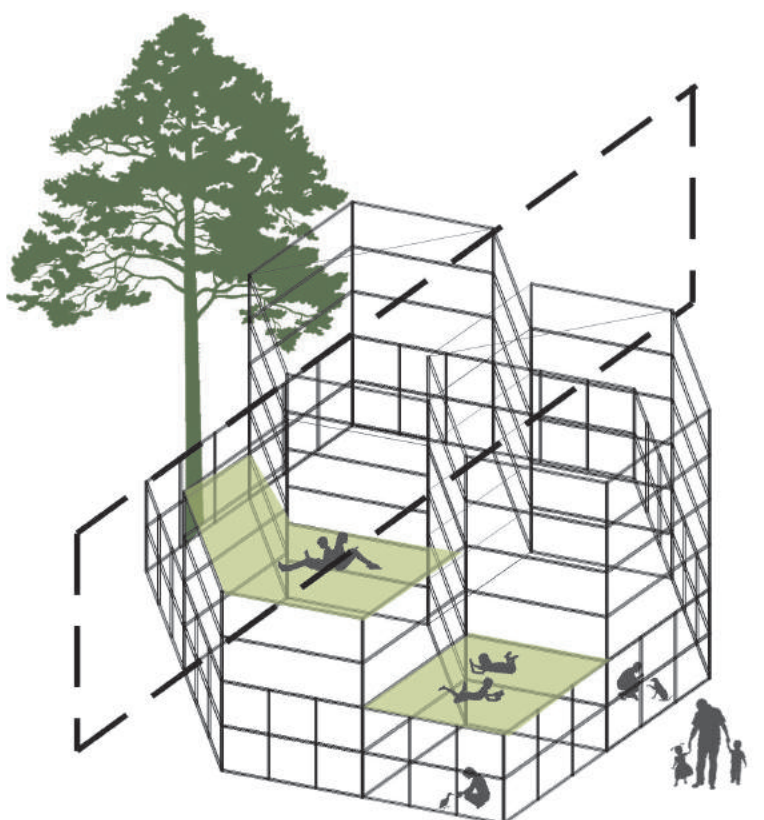

SCIENCE CENTER

Implementation of the space inside zoological and botanic gardens. Location of the library, animal hospital, teaching space.

ZOOLOGICAL AND BOTANIC GARDENS -

space accommodating the plant warm climate, small animals, birds and insects. Each type depending on its needs and characteristics placed in a separate room - a comfortable environment.

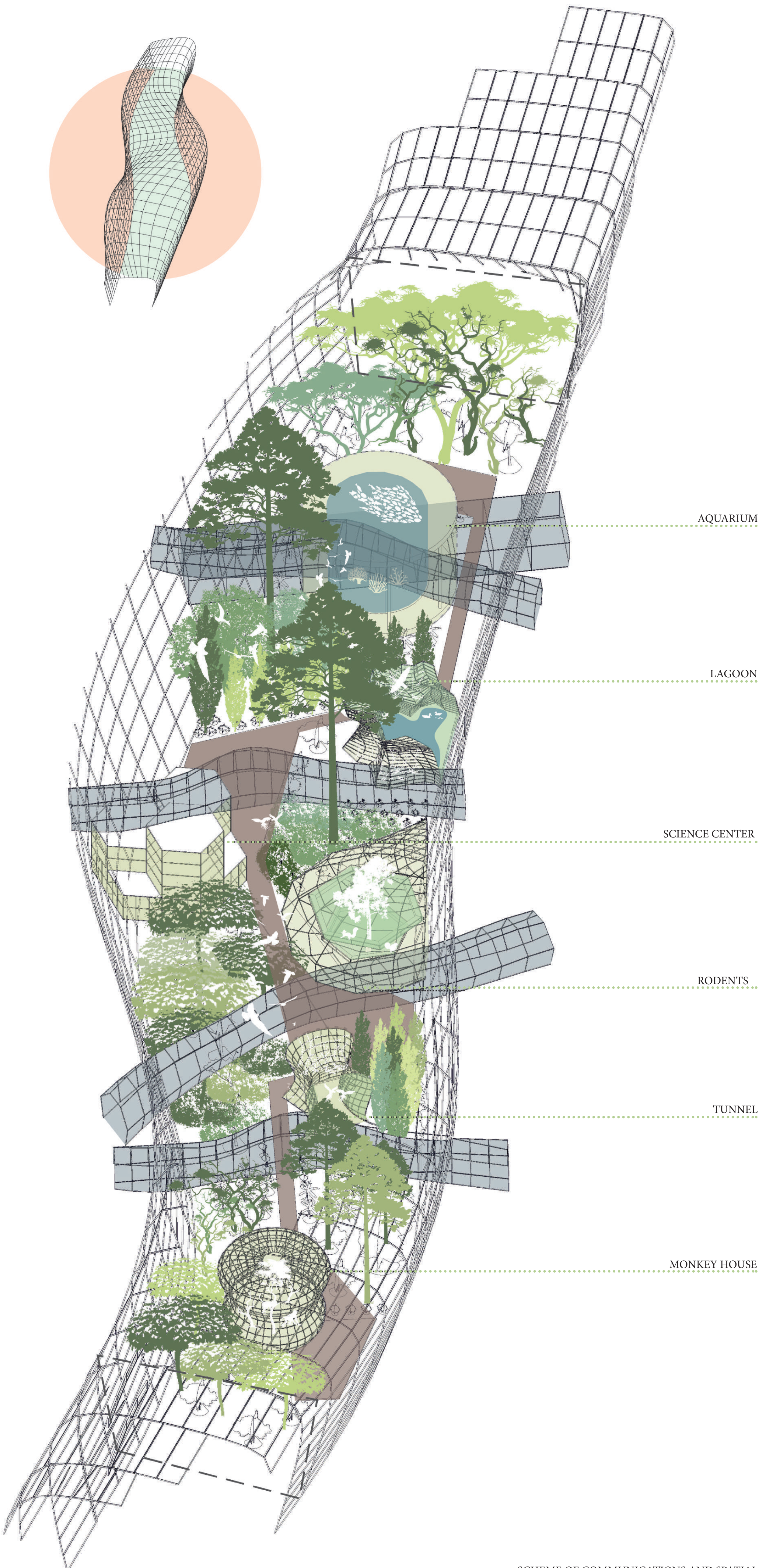
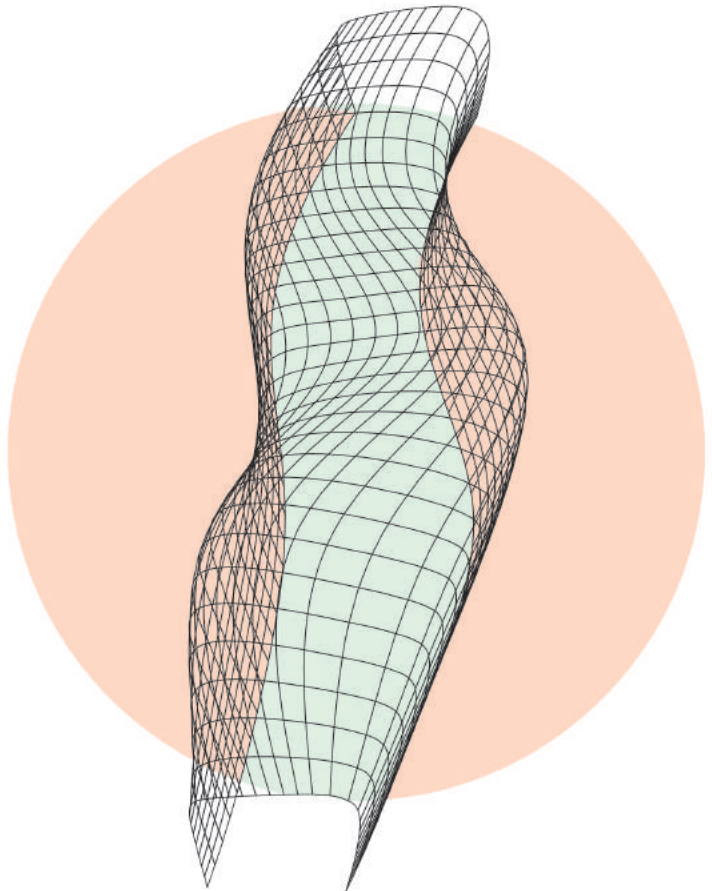

SCHEME OF COMMUNICATIONS AND SPATIAL DISTRIBUTION OF ELEMENTS OF ZOOLOGICAL AND BOTANIC GARDENS

- Internal communication
- External communication



GENERAL PLAN M 1:500

EXPLANATION TO THE GENERAL PLAN

1. Hotel
2. Operating building
3. Block of intensive care
4. Rehabilitation block
5. Administrative block
6. School
7. Food Block
8. The corpus of the public space «Zoobotsad»
9. Sports and recreation complex «Movement»
10. The walking zone «Path»
11. Public space «Mountain Peaks»
12. Sports and entertainment complex «Obstacle stripes»
13. The game complex «Rainbow City»
14. Apple-tree grove «Colors»
15. Public space «Step»
16. Public space «Tetris»
17. Amphitheater «Sun of Lights»
18. Public space «Forest»
19. Embankment «Pierce»
20. Quay «Gables»
21. The game complex «Construct»
22. Public space «Waves»

FACADE M 1:500